

MAX

Unication Group  
Unication USA Inc,  
1901 E. Lamar Blvd., Arlington, Texas, 76006,USA.  
Tel : 817-303-9320 Fax : 817-886-3424  
E-mail : salesenquiry@uni.com.tw

<http://www.uni.com.tw>

T82ALERT02-R

Patent Pending



MAX



Tone Alert and Ring Tone Amplifier



## Tone Alert and Ring Tone Amplifier

For best performance, please insert the alerting device as shown below.  
The position as picture 2- picture 8 are not suggested.

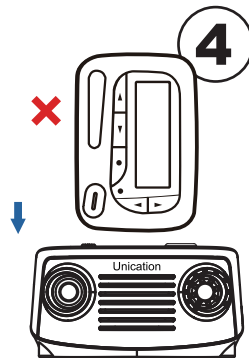
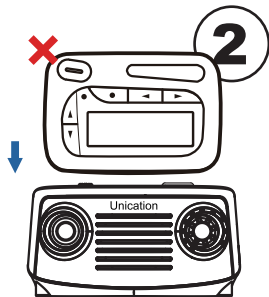
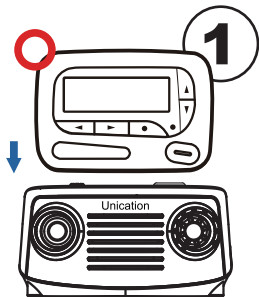

MAX

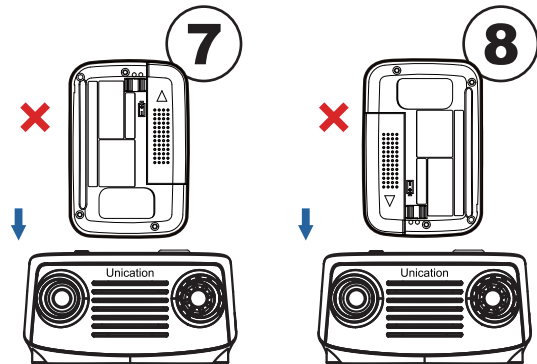
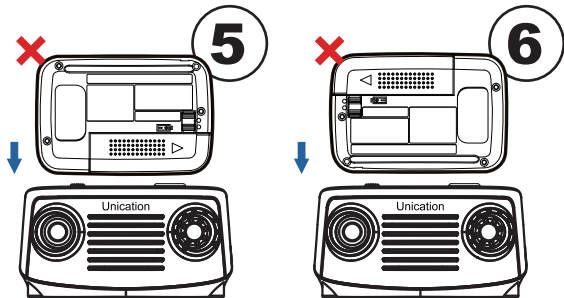



## Tone Alert and Ring Tone Amplifier

### Unication supported products:

Category	Model
Alphanumeric	Alpha Gold, Alpha Elite and Alpha Gold Plus
Numeric, Two-way messaging	NP88, M90 ReFlex

### Other supported products:

Category	Model
Cell phones	The Uni MAX device is compatible with most cellular phones.
Non Unication Pagers	The Uni MAX device is compatible with most pagers.

Thank you for purchasing Unication's product, UNI MAX. UNI MAX will always alert you that your pager has been paged. Its high volume audible alert will always catch your attention. We hope you enjoy using it.

This manual can be downloaded from Unication official website:

<http://www.uni.com.tw>

## Package Content

Your Uni MAX package should include the following items:

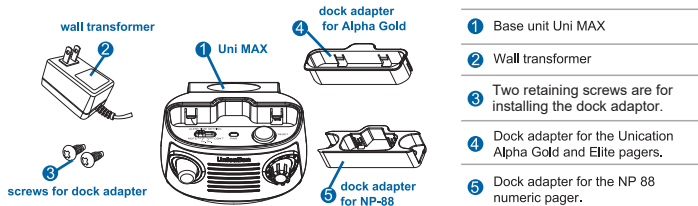



## Tone Alert and Ring Tone Amplifier

### General Information

UNI MAX can be used with pagers or other alerting devices such as cell phones. For best operation, make sure to place the alerting device into its audible tone alert mode, or the alert may not be detected.

#### 1. Operation with your Unication Pager:

For best operation, select the correct dock adapter to match your Unication pager. Then simply set the pager into UNI MAX as shown in the illustrations below.

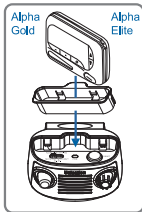
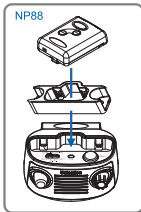
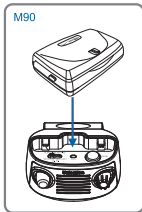

! Before inserting the right pager type dock adapter, please be sure to remove the screws which are fitted inside the socket. After inserting the correct dock adapter, please remember Using the provided screws to secure it.

#### 2. Operation with your Cell Phone:

Your Uni Max is also designed to work with most of the popular models of cellular phones. Please turn the cell phone to any audible alert mode and then place into the Uni Max.

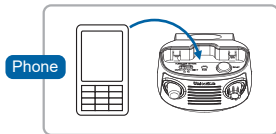

! For better performance, ensure that the cell phone is properly positioned to detect the alert. This may require the cell phone to be set upside-down.

#### 3. Feature and Function Locations

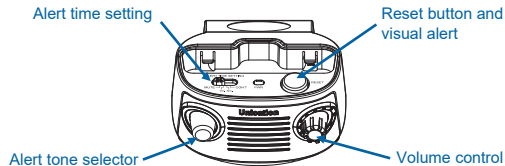



## Charging Uni MAX

Your Uni MAX can use three separate power sources. Using the wall transformer supplied with the unit, installing the optional rechargeable battery pack, or standard AA alkaline batteries only. The Uni MAX will operate normally from the wall transformer, but if the main power is interrupted, the Uni MAX will automatically switch over to the rechargeable batteries.

### NOTE:

- (1) The Uni MAX will only recharge the optional Unication rechargeable battery pack. You can use rechargeable batteries and still leave the wall transformer connected.
- (2) Do not use standard AA batteries with the wall transformer connected.

## 1. Connecting to the Wall Transformer

Connect the power cable to the Uni MAX and then plug the AC transformer into the electrical outlet (90-240VAC).

When the Uni MAX is powered, the GREEN power LED will illuminate.

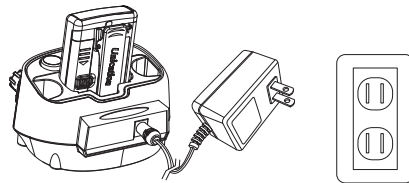

## 2. Installing the Rechargeable Battery Pack

You can use rechargeable battery pack by itself. You can also connect the wall transformer, so the rechargeable battery pack is used as a backup power source. Before installing the rechargeable battery pack, you can remove the wall transformer if needed.

## Tone Alert and Ring Tone Amplifier

MAX

Step1: Remove the retaining screws in the battery door and then lift off the battery compartment cover.

Step2: Then simply insert the pin connector from Battery Pack into the mating connector inside the battery compartment of the Uni MAX unit.

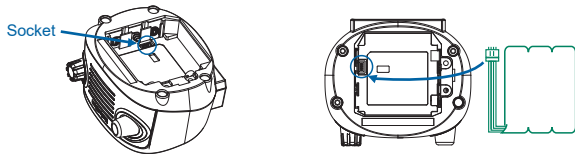

Step3: Reinstall the battery cover and screws, and then plug the wall transformer in to an AC receptacle if needed. After the batteries are inserted, the GREEN Power LED will automatically light.

### NOTE:

To avoid the risk of electrical shock, DO NOT alter the charging or use batteries other than the battery pack intended for this unit.

### 3. Installing the Alkaline Batteries

You can use 3 standard AA alkaline batteries To power the device.

Step1: Remove the retaining screws in the battery door and then lift off the battery compartment cover.

Step2: Observing the correct polarities, insert the AA batteries into the Uni MAX battery compartment as shown below.

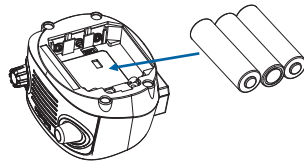

Step3: Reinstall the battery cover and screws. After the batteries are inserted, the GREEN Power LED will automatically light and flash.

### NOTE:

For proper operation, please unplug the wall transformer before using the alkaline batteries.



### 3. LED Indicator

The LED indicator will help you to identify the status of Uni MAX.

Action	With wall transformer	Meaning
Green	Yes	The main power status is normal.
Orange	Yes	Rechargeable batteries are low and charging.
Red	Yes	Rechargeable batteries have problem, and can't be charged.
Flashing Green	No	The batteries are normal.
Flashing Red	No	The batteries are low.
None	No	No power

## Operation

### 1. Alert Tone Selection

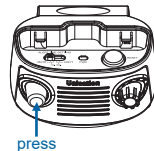

There are ten alert tone types to choose from. Follow the directions below to sample and then to select an alert.

- (1) Listening to current tone alert setting:  
Depress then release the Alert Tone Setting Button to listen to the current alert type.
- (2) Listen to the next alert tone type:  
Depress then release the alert selector switch again and the next alert type will sound.
- (3) Selecting your alert tone:  
When sampling through the alert tones, press and hold the Alert Tone Setting Button once again until a short beep is heard. The current alert type has now been selected.





## Tone Alert and Ring Tone Amplifier

### 2. Volume Setting

Press and turn the volume knob to set an appropriate alerting volume level.

When an alert has been detected, the UniMax will begin the alerting cycle at a low volume and increase to your setting over the time period selected in the following step.

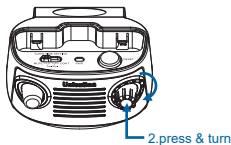
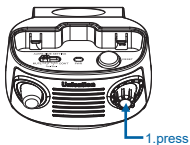

### 3. Alert Time Setting

The Uni MAX will alert audibly and visually when an alert has been detected. You can select the time duration of the Uni MAX alert by adjusting the alert time setting switch. The selections are mute (no audible alert), one minute, three minutes or a continuous alert. Use the selection switch as pictured below to make the selection.

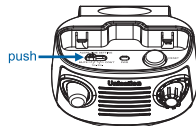

Mode	Meaning
Mute	No audible alert. Visual alert indicator will still be on.
1 min	Audible alert duration is one minute.
3 min	Audible alert duration is three minutes.
Continuous	Audible alert duration is continuous.



## Tone Alert and Ring Tone Amplifier

### 4. Reminder Visual Alert

The Reset Button will keep flashing after an after an alert until it is pressed.

### 5. Stopping the Alert

The alert stops automatically when the selected alert time (1 or 3 minutes) has expired  
You may also press the reset button to stop the alert.

### 6. Operation of the Optional Battery Pack

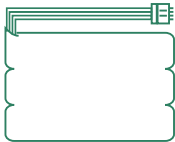

Battery pack charging time : 10 hours maximum from a completely discharged condition.

## Specification

### General Specification

**Alert Tone SPL** : Max. >100 dB @ 30 cm: Min. > 70 dB @ 30 cm (Volume control on minimum)

**Standby Power Consumption** : < 15 mW

**Max. Vol. Power Consumption** : 1.5 Watt

**Operating Temperature** : 0 deg C ~ +50 deg C

**Storage Temperature** : -20 deg C ~ +85 deg C

**Powered by Standard Battery** : AA Alkaline Battery x 3

**Powered by Rechargeable Bat.** : Battery Pack (Ordering part #: T65AMP001 )

**Dimension** : 9.6 X 7.8 X 5.1 cm

**Weight** : 120 gram (Not including battery)

**Certification** : CE / FCC Part 15 B digital device

### Power Adapter Specification

**Input Voltage** : 90 - 240V AC; 50/60Hz

**Output Voltage** : 6 V 2.5 A

**Certification** : CE / FCC Part 15 B digital device, US Energy Star compliance CEC

### Option Accessory Specification

**Powered by Rechargeable Bat.** : Battery Pack (Ordering part #: T65AMP001 )

**Powered by Standard Battery** : AA Alkaline Battery x 3